

Cabineo articles



| Cabineo articles | Art.No. |
|---|---------------|
| Cabineo Starter Set, Cabineo 8 + 12, 40 pcs each, | |
| Cabineo tool with handle, cover caps (40 pcs) | 186305 |
| Cabineo 8, for dividing panels from 16 mm, 500 pcs | 186310 |
| Cabineo 8, for dividing panels from 16 mm, 2000 pcs | 186311 |
| Cabineo 12, 500 pcs | 186320 |
| Cabineo 12, 2000 pcs | 186321 |
| Cabineo tool with handle | 256300 |
| Cabineo hex bit | 276312 |
| Cabineo drill Ø 15 mm | 136312 |
| Cabineo cutter Ø 10 mm | 136310 |
| Cabineo cutter Ø 12 mm | 136311 |

| Cabineo Cover caps | Art.No. |
|--|----------------|
| Plastic Signal white RAL 9003, 100 pc | 186350S |
| Plastic Signal white RAL 9003, 2000 pcs | 186351S |
| Plastic Papyrus white RAL 9018, 100 pcs | 186350P |
| Plastic Papyrus white RAL 9018, 2000 pcs | 186351P |
| Plastic Window grey RAL 7040, 100 pcs | 186350F |
| Plastic Window grey RAL 7040, 2000 pcs | 186351F |
| Plastic Brown beige RAL 1011, 100 pcs | 186350B |
| Plastic Brown beige RAL 1011, 2000 pcs | 186351B |
| Plastic mouse grey RAL 7005, 100 pcs | 186350A |
| Plastic mouse grey RAL 7005, 2000 pcs | 186351A |

Cabineo video



No edge drilling



No dowel holes



One-piece and preinstalled



Fast Assembly



High clamping force



Panels from 12mm thickness



Installation of fixed shelves in assembled units



Simple, Fast and Strong

Machining with all CNC machines

The Cabineo can be drilled or machined

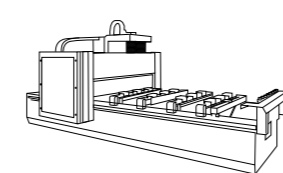

CNC processing centres with pod and rails

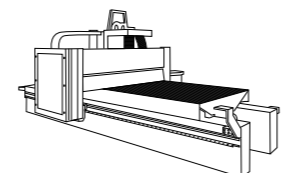

CNC processing centres with nesting technology

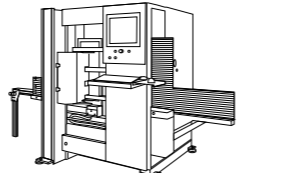

Vertical CNC processing centres

Machining: Side panel

Drill Ø 5 mm
(HPL -> Ø 5.5 mm)

Cabineo 8: X = 8 mm
(Black screw)

Cabineo 12: X = 12 mm
(Nickel plated screw)

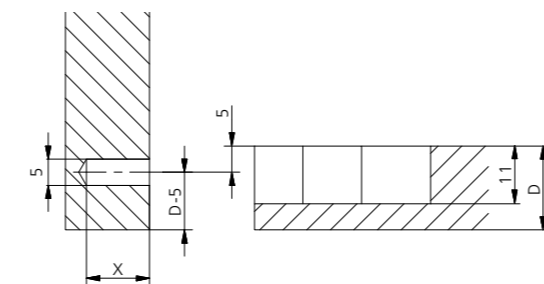

Machining: Bottom, top or fixed shelf

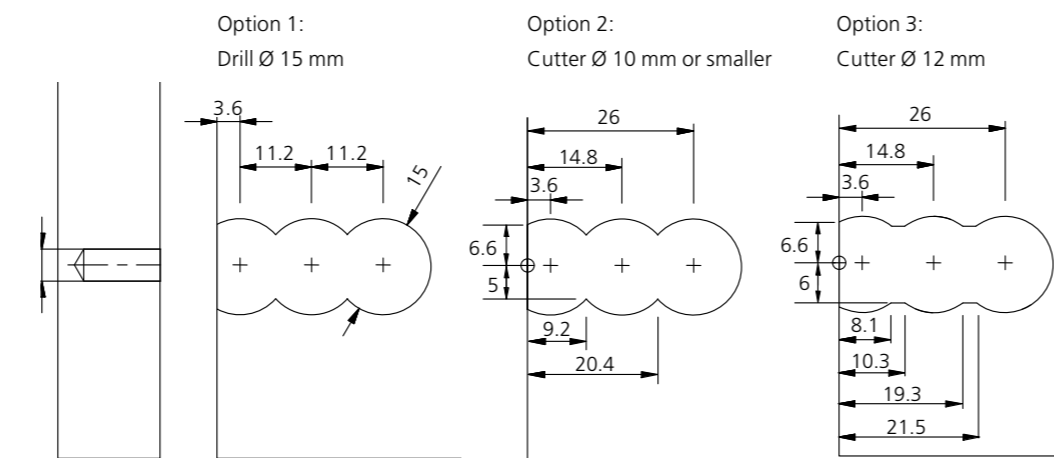

All measurements in mm



Download CAD



www.cabineo.ch

«The new Cabineo connector is simply fantastic! The time saved from processing to assembly won us all over right away.»

Meinrad Keusch, Head of Operations and member of the Board of Directors.
Ruepp Schreinerei AG in Sarmenstorf, Switzerland



Cabineo



Time-saving furniture connector without edge drilling and with very high clamping force



Cabineo the CNC connector of the future!
Simple, Fast and Strong



www.cabineo.ch



Lamello AG
Verbindungstechnik
info@lamello.com
www.lamello.com

Register for more information
cabineo@lamello.com

Art.No. 986300EN

Ideal if you're looking for:

- Faster processing times
- Fewer process steps
- Lower transport volume
- Shorter assembly times
- Stronger connections

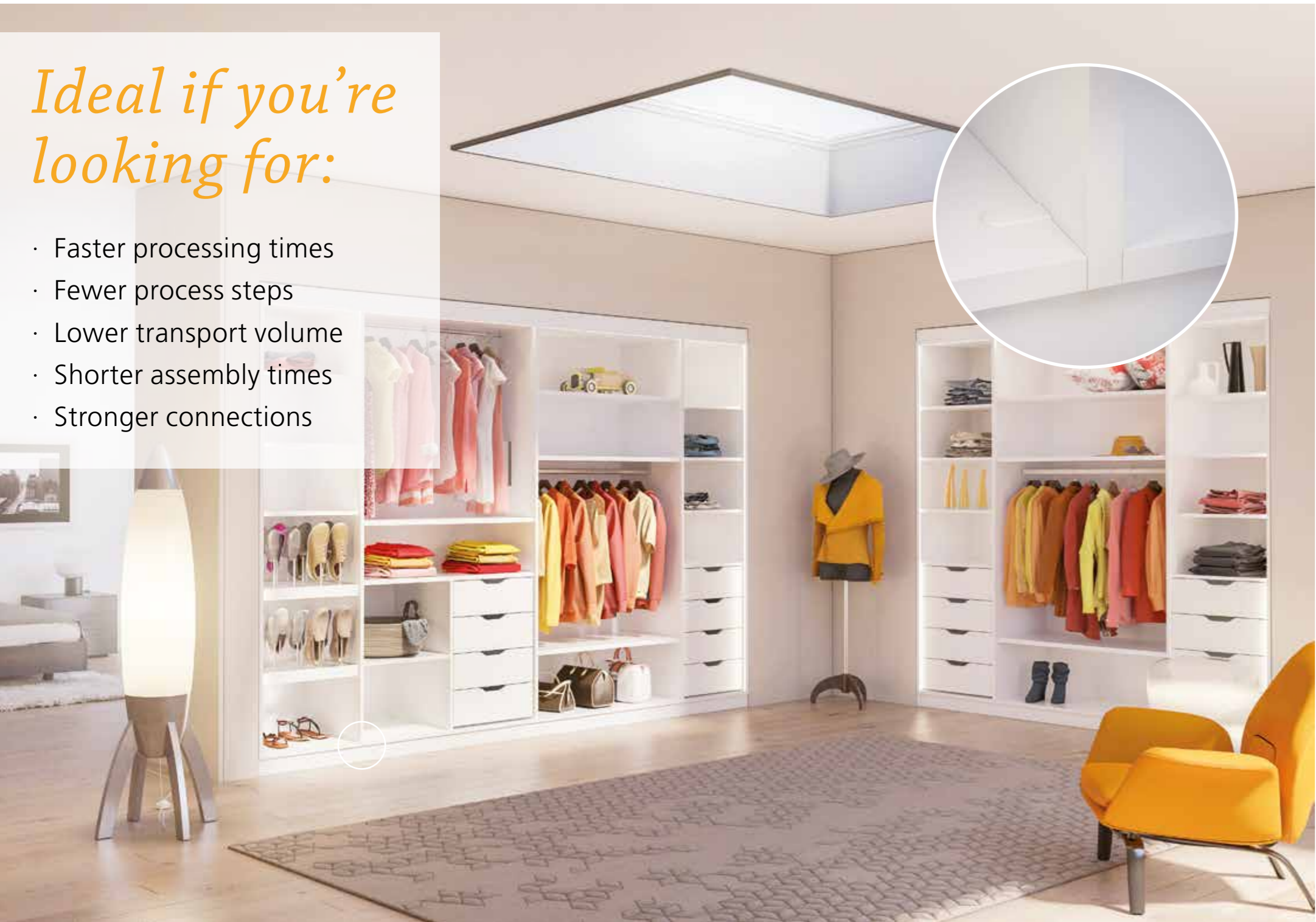

Advantages of Cabineo

1. Time-saving in production

- Optimised process due to surface machining; no edge drilling necessary
- Only one tool change from 5 mm to 15 mm drill; no tool change for the dowel hole drill necessary
- No dowel holes means less drill holes per connector
- Shallow element of 10mm allows for panels from 12mm thickness

No dowel holes
Only one tool change from 5 mm to 15 mm

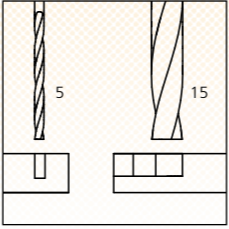

No edge drilling
For the use on CNC with nesting technology

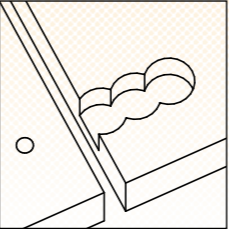

2. Time-saving in transportation

- Efficient pre-installation of the one-piece connector in the factory
- Flat-Pack delivery with pre-installed connectors
- No extra bags or loose hardware required with furniture shipment
- Detachable for transport or if the fixed shelves need adjusting

One-piece and preinstalled
No bags with hardware and faster assembly

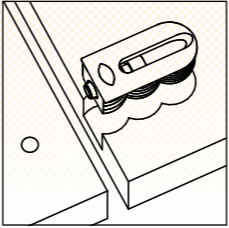

3. Time-saving in the assembly

- One-piece connector without dowels; no pre-assembly of screws or dowels in the side panels necessary
- Easy positioning of the Cabineo in the corresponding hole due to the protruding screw
- Fast assembly with a cordless drill
- Installation of fixed shelves or vertical dividers in an already assembled unit

Fast Assembly
No pre-installation of screws or dowels

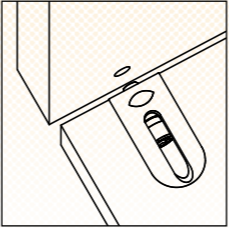

High clamping force
Strong connections, clamped powerfully

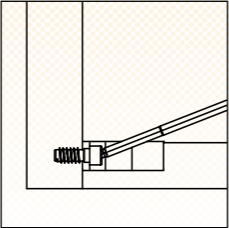

Comparison with cam and dowel

| | |
|---|--|
| <p>Manufacturing process with Cabineo</p> <ul style="list-style-type: none"> 4 surface processing steps 1 tool change <p>Fit Cabineo into top or bottom shelf</p> <p>Flat pack the workpieces</p> <p>Assemble using a cordless drill</p> | <p>Manufacturing process with cam</p> <ul style="list-style-type: none"> 3 surface processing steps 2 tool changes <p>2 edge drill holes 1 tool change <p>Prepare fitting bag</p> <p>Flat pack the workpieces</p> <p>Insert cam into shelf</p> <p>Install the screw in the side</p> <p>Insert dowel into the side</p> <p>Assemble using a screwdriver</p> </p> |
|---|--|

«Cabineo focuses on the essentials. Its huge potential becomes even clearer when you look at its positive impact on the entire value chain.»

Jan Fischer, Product Manager at Lamello AG

